

**BRUNEL**  
CARDIFF



SUITES



# CITY CENTRE WORKSPACE

Brunel Cardiff offers flexible office suites from 559 - 2,680 sq ft – ready for occupation from day one.

Located on the 9th floor, the suites feature stunning views and unrivalled on-site amenities including communal lounges, Kin & Ilk café and on-site crèche.



1. Building entrance
2. Communal lounge
3. Kin & Ilk café



Kin & Ilk café and communal lounges



Adjacent to Cardiff Queen Street Station







# ALL BASES COVERED

The building provides an impressive range of facilities to enhance your working environment.

The suites are furnished to a high standard, with pre-connected high speed internet and best-in-class security systems.



Reception concierge  
& 24hr security



Fully furnished &  
fibre ready



Single card access  
into suites



Private  
meeting rooms



End-of-journey  
facilities



On-site café and  
communal lounge



On-site  
car parking



On-site  
crèche



# READY FOR WORK



## HIGH SPEED INTERNET



**Each suite benefits from Cat 6 data cabling with pre-connection in place.**

Bespoke solutions including extra racking space and extra security if required.

The network runs 24/7 and we have a dedicated team of support staff to answer any questions you may have.

A small set up cost and monthly fee applies.

## ON-SITE SECURITY TEAM



**A secure workplace to relax and do what you do best.**

In addition to the staffed reception, we have an on site security team to keep everything running smoothly.

The building features Assa Abloy Security, modern fire alarms and CCTV systems.

## BUSINESS SPACES



**A thriving community of businesses big and small.**

If you need to host your customers or clients why not use the facilities within our shared workspace provider Clockwise.

Based on the first floor, Clockwise have a range of meeting and conference rooms available for hire.

## HIGH QUALITY FINISHES



**Bright and airy spaces with contemporary design details.**

The suites all include climate control, fully equipped kitchenettes, branding and signage in place.

They are available fully carpeted with suspended ceilings and a range of furniture options.



## AMENITIES

# PLUG & PLAY SUITES AT BRUNEL

Thoughtfully designed offices with flexible leases - getting straight to work couldn't be easier.

The suites offer excellent natural light, panoramic city views and access to fully equipped kitchenettes.



Suites from  
6 - 32 desks



Teapoints &  
breakout areas



# FLEXIBLE SPACE

Suites are available in a range of sizes and configurations with meeting rooms and breakout areas to suit occupier needs.

## Suite 1

2,680 sq ft / 249 sq m

24 – 32 desks  
8 person meeting room  
2 x breakout areas

## Suite 2

559 sq ft / 52 sq m

6 – 10 desks

## Suite 3

990 sq ft / 92 sq m

10 – 16 desks  
8 person meeting room  
Breakout area

## Suite 4

635 sq ft / 59 sq m

8 – 10 desks  
Breakout area

## Suite 5

850 sq ft / 79 sq m

8 – 10 desks  
Breakout area

## Suite 6

1,162 sq ft / 108 sq m

14 – 16 desks  
8 person meeting room

## Suite 7

828 sq ft / 77 sq m

7 – 10 desks  
8 person meeting room

## Suite 8

667 sq ft / 62 sq m

6 – 8 desks  
Breakout area

## Suite 9

1,044 sq ft / 97 sq m

12 – 14 desks  
Breakout area



## Suite 10

2,292 sq ft / 213 sq m

18 – 20 desks  
10 person meeting room  
2 x breakout areas

## 9TH FLOOR SUITES

10 SUITES  
FROM 6 - 32 DESKS

Additional desk positions  Office  Core 

Fitzalan Road

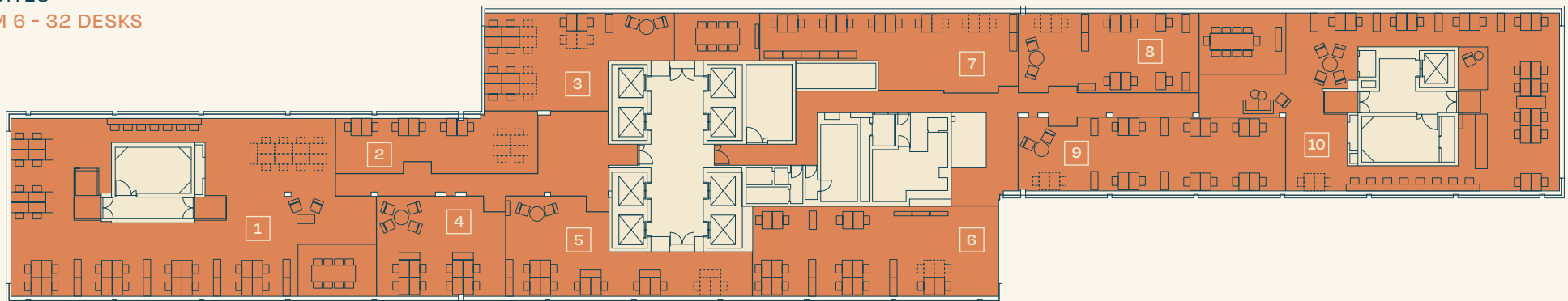

For indicative purposes only. Not to scale.

# PRIME CITY CENTRE LOCATION

Located in the heart of Cardiff's lively and welcoming City centre, offering a vibrant mix of amenities and culture.

You'll find everything you need, from fine-dining to street food, lively bars to artisan cafés.

Connectivity is excellent as the building is conveniently located adjacent to Cardiff Queen Street Station – making transport around the city as well as Swansea and London simple.



## JOURNEY TIMES

**3** mins

Cardiff Queen Street Station

**15** mins

Cardiff Central Station

**04** mins

Cardiff Bay Station



### Bars & Cafés

1. The Alchemist
2. Flight Club
3. Black Sheep Coffee
4. 200Degrees Coffee
5. The Dead Canary
6. Bigmoose Coffee
7. Coffee Planet
8. Uncommon Ground
9. Glassworks
10. Brewhouse

### Restaurants

1. Coppa Club
2. The Ivy
3. Steak Of The Art
4. Pasture
5. Lezzet
6. Daffodil
7. Urban Kitchen
8. Gaucho
9. Cosy Club
10. The Corner House

### Leisure

1. Cardiff Castle
2. Utilita Arena
3. Cardiff Market
4. Cineworld
5. Treetop Golf
6. The Botanist
7. Principality Stadium
8. Museum of Cardiff
9. TheGym
10. The Live Lounge

### Hotels

1. Mercure Cardiff
2. Hotel Indigo
3. The Parkgate Hotel
4. Hilton Cardiff
5. Clifton Hotel
6. Marriott Hotel
7. Royal Hotel
8. Park Plaza
9. Leonardo Hotel
10. Easy Hotel





# FURTHER INFORMATION

## VIEWINGS

Strictly through the joint sole letting agents:



**Mark Sutton**  
07919 395 593  
[mark.sutton@knightfrank.com](mailto:mark.sutton@knightfrank.com)

**Tom Eddolls**  
07976 730 173  
[tom.eddolls@knightfrank.com](mailto:tom.eddolls@knightfrank.com)



**Mark Siddons**  
02920 346 361  
[mark.siddons@coark.com](mailto:mark.siddons@coark.com)

**Ben Bolton**  
02920 346 376  
[ben.bolton@coark.com](mailto:ben.bolton@coark.com)

**BRUNELCARDIFF.CO.UK**

Knight Frank and Cooke & Arkwright on their own behalf and for vendors or lessors of this property, whose agents they are, give notice that: 1/ The particulars are produced in good faith, but are a general guide only and do not constitute any part of a contract. 2/ No person in the employment of the agent(s) has any authority to make or give any representation or warranty whatsoever in relation to this property. 3/ The property is offered subject to contract and unless otherwise stated all rents are quoted exclusive of VAT. 4/ Nothing in these particulars should be deemed a statement that the property is in good condition, or that any services or facilities are in working order. 5/ Unless otherwise stated, no investigations have been made regarding pollution, or potential land, air or water contamination. Interested parties are advised to carry out their own investigations if required. September 2024.

Designed by CreSte - 020 3468 5760 - [creste.london](http://creste.london)